



Riviera Acrylic Round

# Riviera Acrylic Shower

## 2 Sided Round Sliders



### RIVIERA SLIDER DOOR

- 6mm safety glass to New Zealand standards.
- 1850mm high door and returns.
- Twin sliding doors do not open into room.
- Smooth roller system. *NB. As with all ball bearing systems the rollers need to be lubricated to ensure they keep functioning as intended.*
- Polished alloy frames.
- Frame reversible.
- Splash safe full length door seal.
- Door seal removable and easily cleaned.
- Magnetic door closure.
- Chrome handle.
- Quick release wheels.
- Tapware and accessories not included.

### NEWLINE ACRYLIC TRAY AND WALLS

- Made in New Zealand.
- aquaCHECK technology to prevent water damage.
- Supplied with NEWLINE Easyclean Waste
- Non-slip tread pattern.
- No silicone inside shower.
- One piece acrylic wall lining.
- Two Moulded wall options available:
  1. Side contour with moulded shelves.
  2. NEW corner contour with 3 glass shelves.
- All dimensions from the outer edge of the acrylic tray nominal.
- Supplied with glue and sealant pack.
 

*NB. Warranty void if recommended glue and sealant not used.*

### SPECIFICATIONS

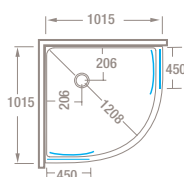

**RIVIERA Acrylic 1015 Round**

Shower height: 1920mm  
 Door opening: 480mm  
 Sill height: 70mm  
 Low Profile Tray

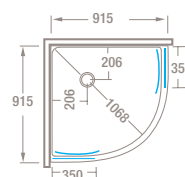

**RIVIERA Acrylic 915 Round**

Shower height: 1915mm  
 Door opening: 480mm  
 Sill height: 65mm  
 Low Profile Tray